

# M3

## Pressure balance mixing valve

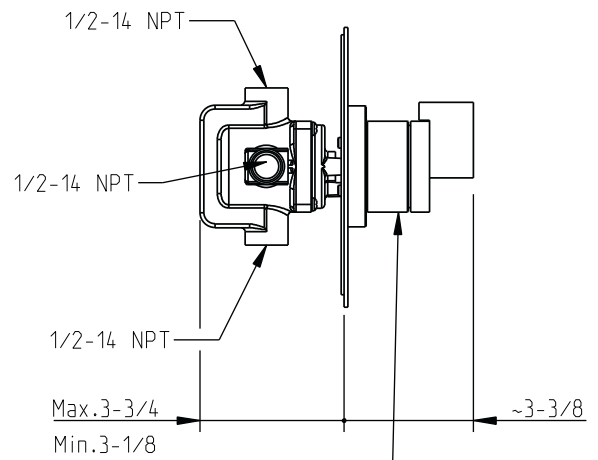
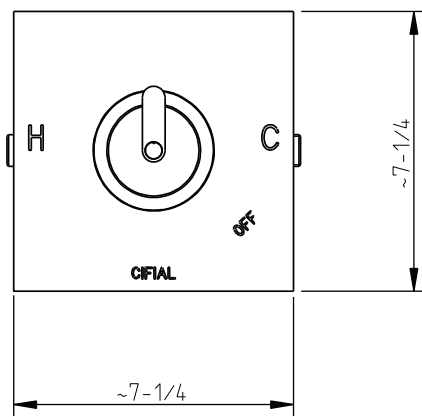

identification and c-UPC certification label

Rough: 289 705 999 (sold separately)

dimensions inches



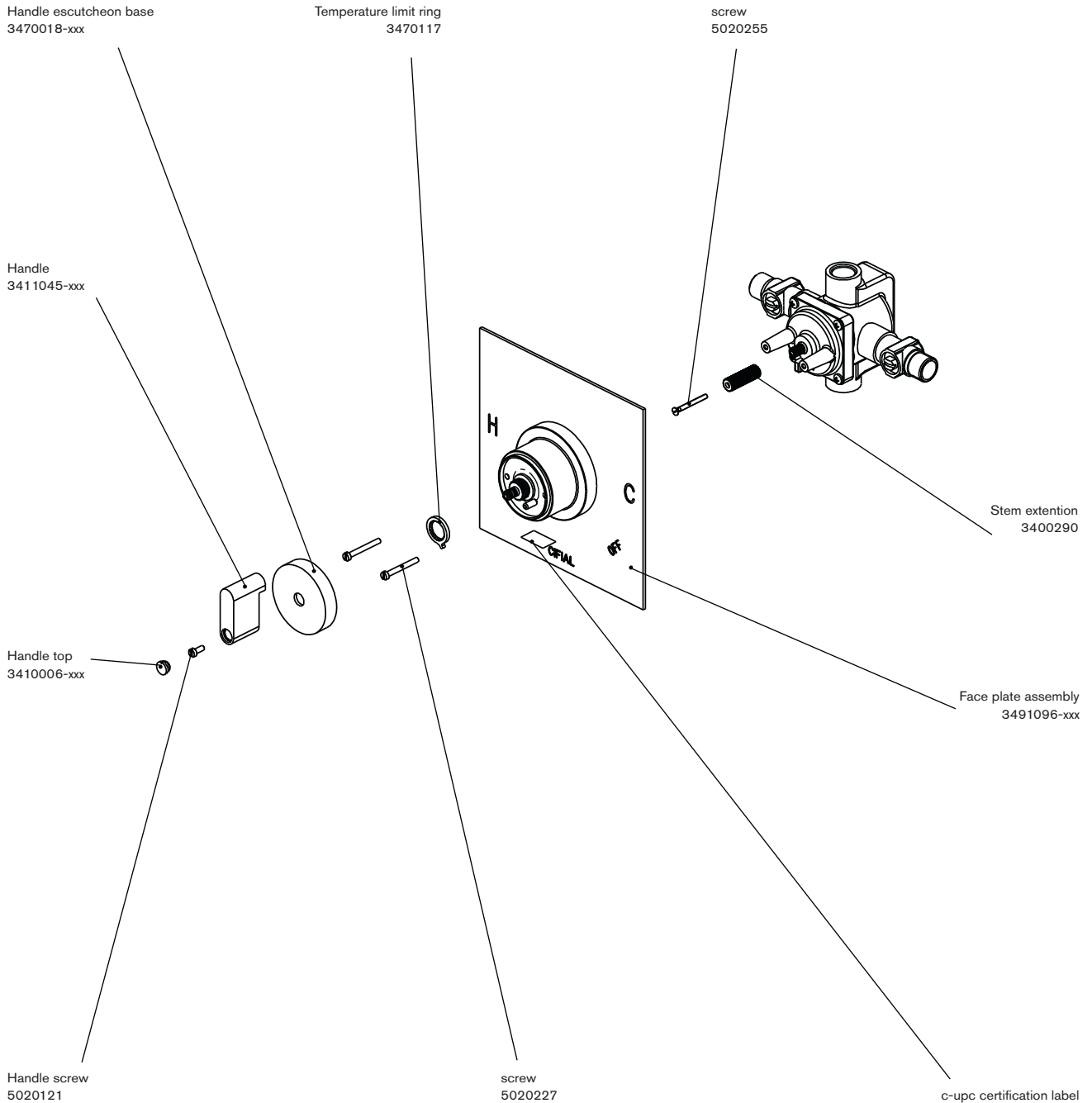

## assembly instructions

- 1 - Pressure balance rough valve is sold separately.
- 2 - Place stem extension onto valve stem.
- 3 - Slide face plate assembly into place and engage stem extension into handle drive shaft using face plate screws.
- 4 - Set temperature limit ring by turning handle drive shaft counter clockwise until desired maximum temperature (43° c/110°F) is reached. Place limit stop onto handle drive shaft with arm set next to limit stop pin. Turn handle drive shaft clockwise to shut off valve.
- 5 - Place handle escutcheon base and handle onto handle drive shaft so that the handle stands in the off position (5 o'clock). Tighten with handle screw and insert handle top.

